

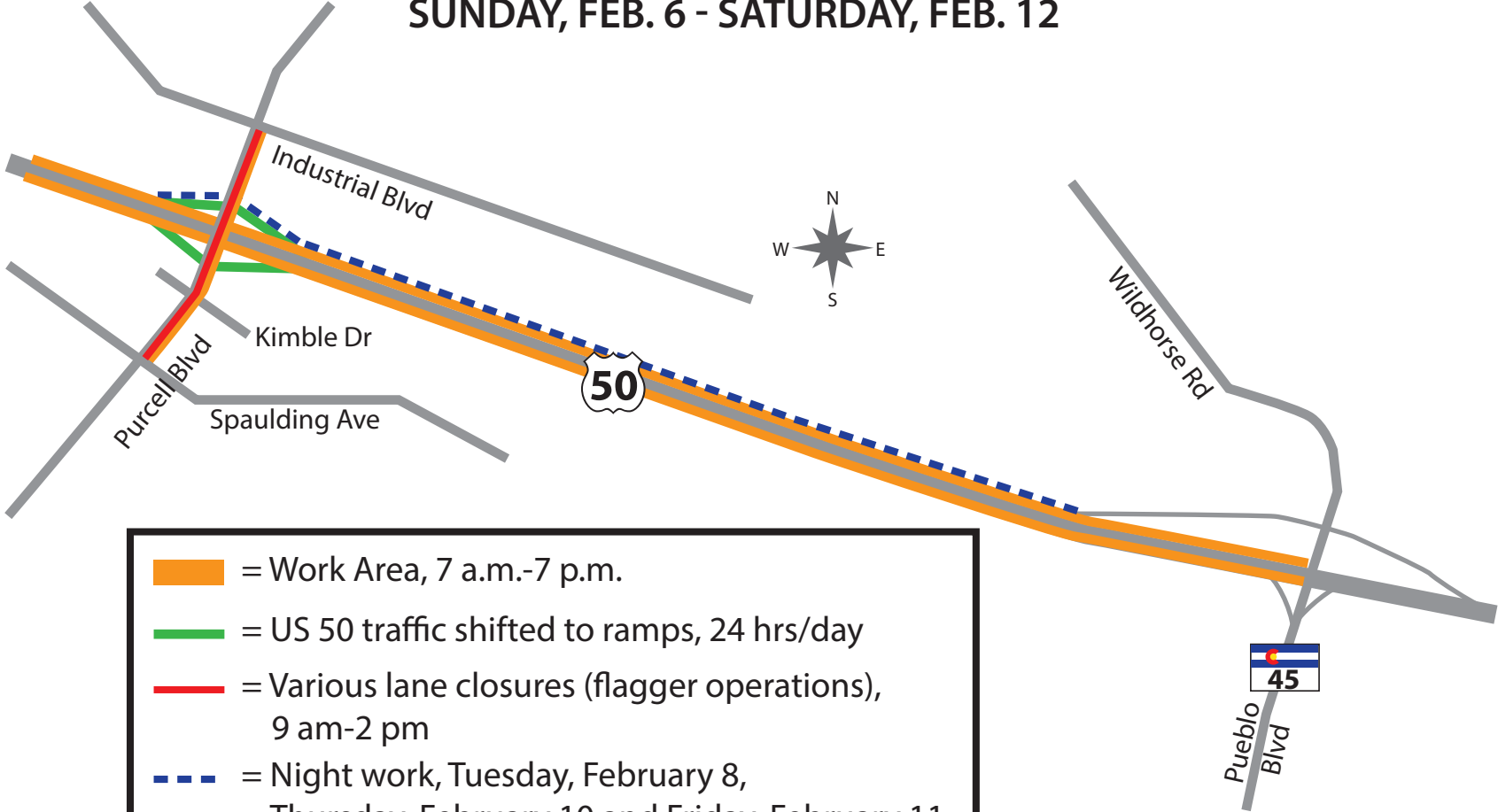



SUNDAY, FEB. 6 - SATURDAY, FEB. 12



-  = Work Area, 7 a.m.-7 p.m.
-  = US 50 traffic shifted to ramps, 24 hrs/day
-  = Various lane closures (flagger operations), 9 am-2 pm
-  = Night work, Tuesday, February 8, Thursday, February 10 and Friday, February 11, 7 pm-7 am